

New Student Commons and Administrative Refurbishment

**And the Impact of Construction on
the 2011 – 2012 School Year**





Bishop Kelly learned in early March that the school is the recipient of a \$500,000 grant from the E.L. Wiegand Foundation. This wonderful news put the wheels in motion for us to proceed with an exciting new building project at Bishop Kelly called The Commons Project.

The Commons Project is the final and capstone phase of building and renovations planned in BK's Capital Campaign, which began in 2006. While we are still fundraising so that the project will be fully funded upon completion in January, we are poised to move forward with demolition and construction in the coming weeks.

The following pages outline the programmatic needs addressed by the Commons Project and give more detailed information about the space, the fundraising taking place, and how campus will be impacted by construction.

Programmatic needs addressed by The Commons Project

- Adds convocation space for student and community gatherings.
- Adds a 100 person, wireless, multipurpose room for large group instruction, presentations, club and activity meetings, college visits, testing, and other large common gatherings.
- Provides a space for students to study before and after school.
- Adds a sculpture that reflects our Catholic identity.
- Co-locates the counselors and provides a counselor waiting area and college resource area.
- Enhances security by creating visitor control and monitoring at the front entrance.
- Provides an adequate nursing station with privacy, an isolation area, and security.
- Organizes administrative areas by function and recovers unusable space.
- Provides a restroom on the south side of the school adjacent to the cafeteria and chapel.
- Modernizes the exterior appearance of the school, creating a campus environment that compliments our academic excellence and enhances our ability to attract new students to Bishop Kelly.



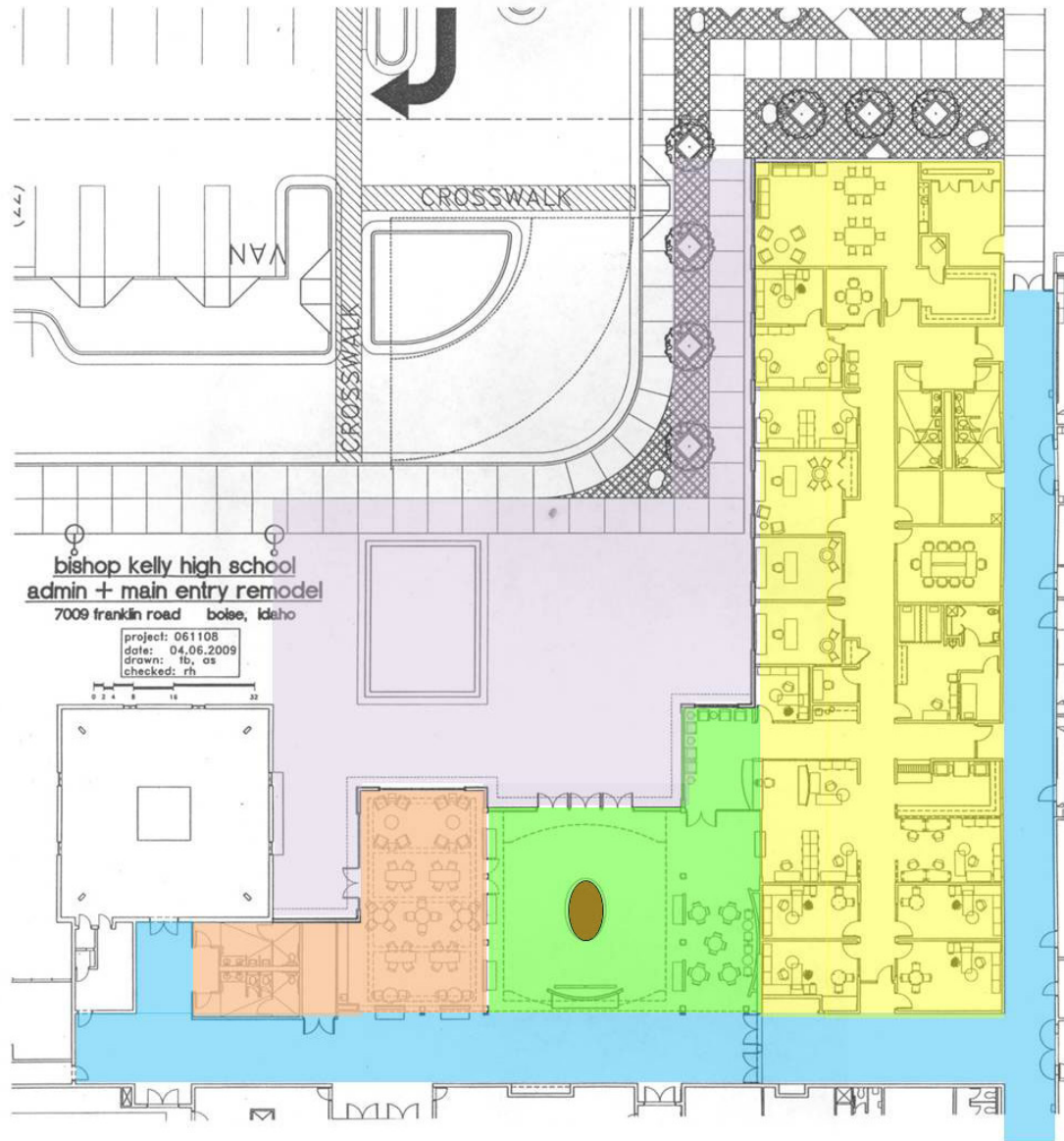

The Commons Project at Bishop Kelly High School

Legend

- New convocation space.
- 100-person multi-purpose room, study area, and restrooms.
- Three piece bronze sculpture created by art faculty member, Michael Dente and students at BK.
- Remodeled space for counselors, college resource room, nursing station, administration, teacher work room, and add an admin infill.
- Remodeled and landscaped entrance and patio area - to include granite pavers, benches, trees, shrubs, and irrigation.
- Existing hallway will have asbestos removed and be retiled.





1. Front Elevation and Plaza
2. Front Elevation from Parking Lot
3. Interior Convocation Space, looking toward Franklin Road





100 Person Wireless Multi-purpose Room

One to the main features of the new commons will be a 100 Person, wireless, multi-purpose room. Our program needs and research into newly constructed high schools both validate the need for multi-purpose space. Our commons will include such space.

This space will be a place for students to gather or study before and after school and during breaks. It will provide space for clubs and activities to meet. It will support a large class, or group presentation, such as a college visit. Our many boards and committees will have adequate meeting space. The free flow from this space into the commons, patio, and cafeteria will allow its use for alumni, foundation, student, and community events. A flexible furniture plan will allow rapid and easy reconfiguration of the room.

Space design includes extra electrical outlets for charging, multiple wireless entry points, an overhead projector and a mobile whiteboard. Ample technology and growth options will support study, meetings, and instruction in the space, as well as our longer term movement toward a one-to-one mobile device learning environment. Students should be able access the web and Blackbaord to study while waiting for transportation or around classes.



Administrative Area Renovation

The long overdue renovation of the administrative and student services portion of our facility will nearly complete a full renovation of our existing space since 2005. It will greatly enhance both the administration and student services functions. While some new space will be added to the footprint, all the existing space will be reorganized into three functional areas, Student Services, Administration, Faculty Space.

Student services will co-locate all support staff that works directly with students (Front Office, Attendance, Counselors, Chaplin, Nurse). Administration will include, Principal, Vice Principal, Enrollment, and Business Office functions. A mid-sized meeting room and restroom will also be included in this section. The faculty section will include a faculty lunch room and a faculty work/prep room.



The Sculpture

The entrance to the commons is intended to embody who we are as a community and reflect our mission of educating the whole student - spirit, mind, and body in the Catholic tradition. Ample display cases will allow for presentation of our community's many accomplishments in mind and body. Displays could include a piece of art, a written composition, an athletic trophy, an alumni or faculty profile, or a historical display.

These celebrated temporal accomplishments will be centered on the spiritual, represented by a bronze sculpture depicting the baptism of Christ. Jesus of Nazareth began his adult mission as Jesus the Christ with his baptism. This piece metaphorically encourages our students to accept their spiritual mission as they graduate and begin their adult lives. Conceptually, this sculpture reflects a longstanding Bishop Kelly belief that; "Jesus Christ is our ultimate teacher and role model. "

This original sculpture is being commissioned by BK from our own sculptor in residence, Michael Dente. Mr. Dente is encouraging interested students and interested members of the BK family to help him create the sculptures of Jesus and John the Baptist prior to casting.

The Knights of Columbus building on our campus has been transformed into a studio for construction of this piece. As this is being written, the form of Jesus is taking shape. It is exciting to see this incredible vision come to life! (These photos are representative of the concept only.)



Project Funding Status

as of June 14, 2011

The Wiegand grant is a critical piece of the puzzle that allows us to move forward with the planning of the commons project. Other funding sources include Building Committee funds, capital campaign pledges, new pledges to the campaign and a generous gift from the Albertson Foundation.

When BK first started planning for this project in 2007 the estimated cost to build was \$3.2 million. In today's soft building market our cost has been reduced to \$2.4 million dollars. That gives the project a sense of urgency. And our early fundraising efforts give us the confidence to move forward, while we continue to raise the monies we need to have the project fully funded upon completion.

As a matter of policy, the Building Committee will not encumber the operations of Bishop Kelly High School with construction or modernization debt. When this project moves forward it will not impact tuition.

Total Project Cost	\$2,200,125
Wiegand Grant	\$ 500,000
Albertson Foundation	\$ 250,000
Building Committee Funds	\$ 200,000
Campaign Pledges	\$ 120,000
Six New Pledges (as of June 3 rd)	\$ 500,000
<hr/>	
Shortfall	\$ 630,125



Construction Timeline

June 1, 2011	Temporary Admin offices arrive on campus
June 15, 2011	Move of Admin/Counseling/Nurses offices to temporary space begins
June 15, 2011	City permits in hand (Conditional use application approved 3/22)
June 23 , 2011	Call for bids
July 11, 2011	Demo and asbestos removal begins
July 26, 2011	Award contracts
August 10, 2011	Commence construction
Dec. 30, 2011	Complete construction, certificate of occupancy
January 30, 2011	Complete move in

As you can see by the above timeline, several areas of campus will be impacted through fall semester of 2011. Specifically BK's main office, including the counselors' offices, will be located in portables. Our new "front door" and main offices will move to the rear of the building just outside the cafeteria. Please be assured that we are working with the contractors to make sure that our students will be able to move around their school safely and securely during construction. We will all be impacted by construction at BK over the next several months. But in the end, our beautiful and functional new Commons will be worth it!





Thank you for your patience and support as we modernize and grow our facility. These improvements will enable us to better support our programs and mission so that Bishop Kelly High School can continue to graduate students who are well prepared for success at the next level and in life.

